



**FORTUNE & COATES**

The People's Estate Agent

<https://www.fortuneandcoates.co.uk>



**19 Bury Road, Harlow, CM17 0ED**

**Guide price £390,000**

£390,000 - £410,000

Fortune and Coates are delighted to welcome to the market this beautiful two bedroom semi-detached family home situated in Bury Road, Old Harlow.

As you step inside, you are greeted by a bright and inviting living room, bathed in natural light, making it an ideal space for entertaining family and friends. The living room seamlessly flows into a convenient dining room, perfect for family meals and gatherings, with ample space for a fridge/freezer and easy access to the first floor.

Adjoining the dining area is a well-appointed kitchen, featuring a range of wall and base units, an integrated oven and hob, and a sleek grey tiled splashback. The kitchen is designed for modern living, with plumbing for a washing machine and dishwasher, and a patio door that opens directly to the rear garden, enhancing the

Living room 10'7" x 15'10" (3.25 x 4.83)

Dining room 11'1" x 11'7" (3.38 x 3.55)

Kitchen 7'1" x 9'5" (2.17 x 2.89)

Bedroom 11'1" x 10'11" (3.40 x 3.33)

Bedroom 8'5" x 11'7" (2.59 x 3.55)

Dressing room 7'1" x 9'5" (2.17 x 2.89)

AGENT NOTE: The information provided about this property does not constitute or form part of an offer or contract, nor may it be regarded as representations. All interested parties must verify accuracy and your solicitor must verify tenure/lease information, fixtures & fittings and, where the property has been extended/converted, planning/building regulation consents. All dimensions are approximate and quoted for guidance only as are floor plans which are not to scale, and their accuracy cannot be confirmed. Reference to appliances and/or services does not imply that they are necessarily in working order or fit for the purpose.



Floor Plan

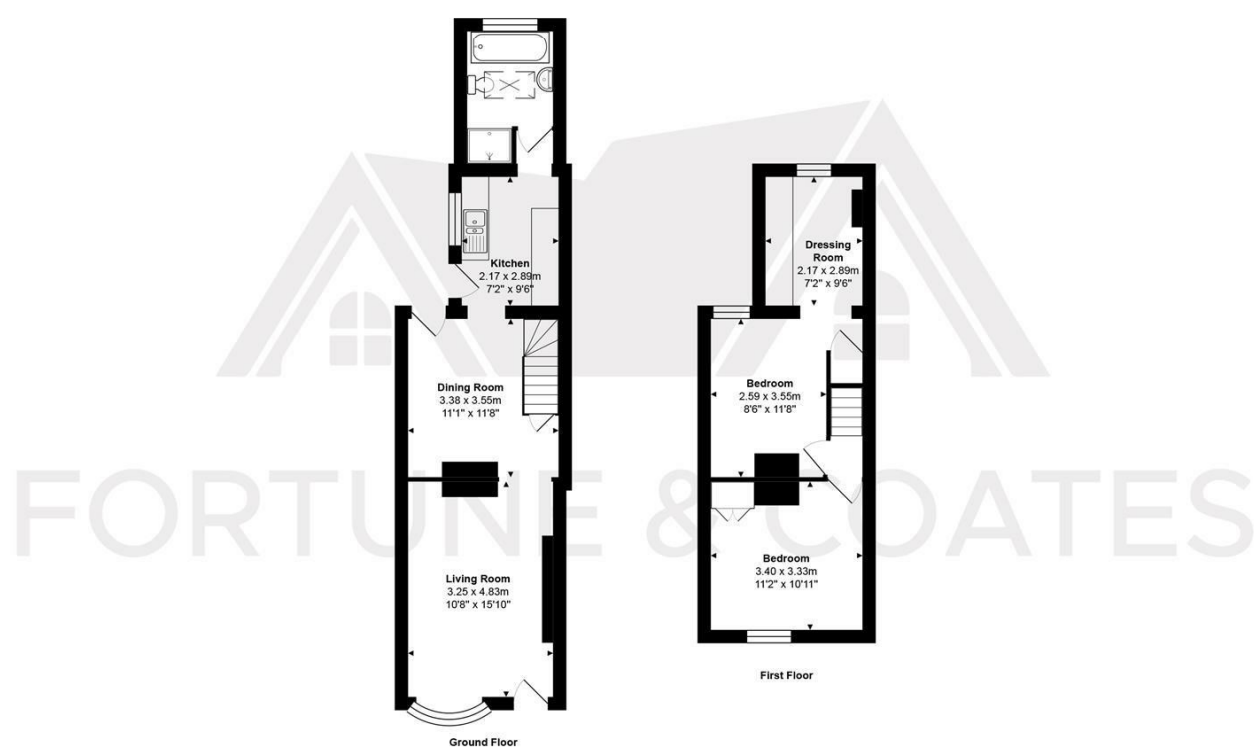

Total Area: approx. 72.3 m² ... 778 ft²  
THE FLOORPLAN IS FOR ILLUSTRATIVE PURPOSES ONLY AND IS NOT TO SCALE.  
Measurements and features are approximate and may differ from the actual property. Verify all details independently; no liability is accepted for errors or omissions.  
Property marketing provided by www.fotomarketing.co.uk

Area Map

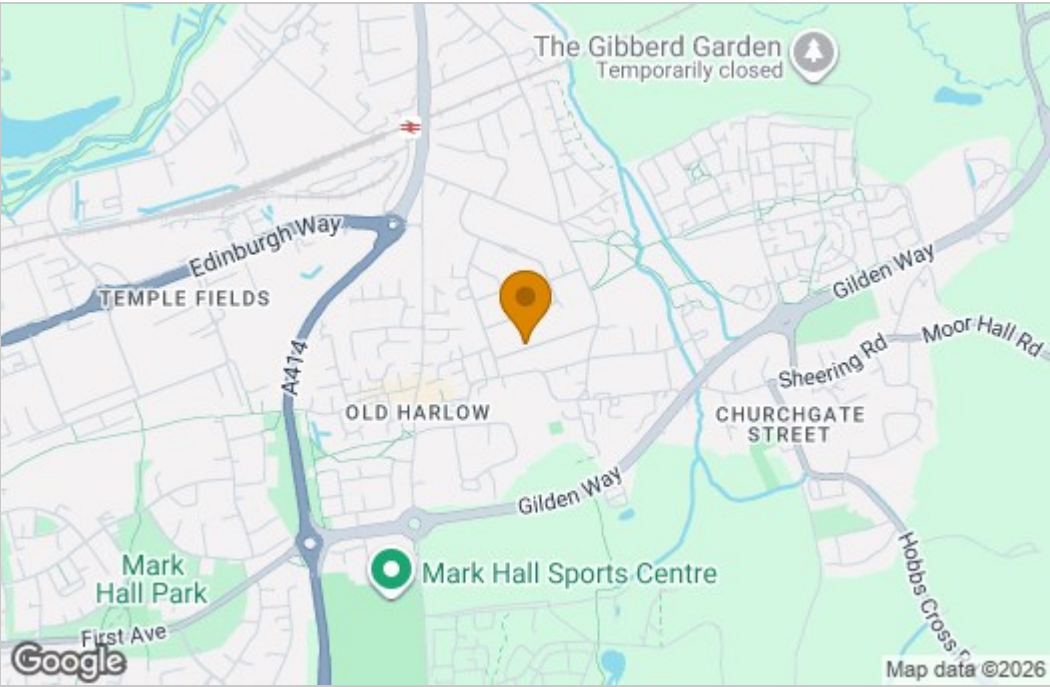

Energy Efficiency Graph

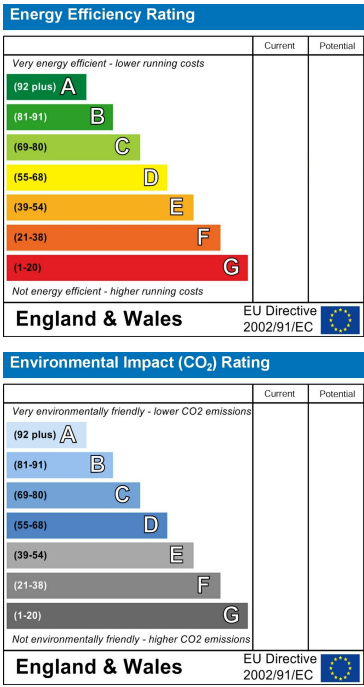

These particulars, whilst believed to be accurate are set out as a general outline only for guidance and do not constitute any part of an offer or contract. Intending purchasers should not rely on them as statements of representation of fact, but must satisfy themselves by inspection or otherwise as to their accuracy. No person in this firm's employment has the authority to make or give any representation or warranty in respect of the property.